

HOOB CYBER

HOOKAH USER'S GUIDE

BEFORE FIRST USE

Please read this user manual carefully.

- Remove the hookah parts and accessories from the packaging.
- Rinse the hookah parts and accessories with water.
- Dry the parts and assemble the hookah according to the instructions.

HOOKAH EQUIPMENT

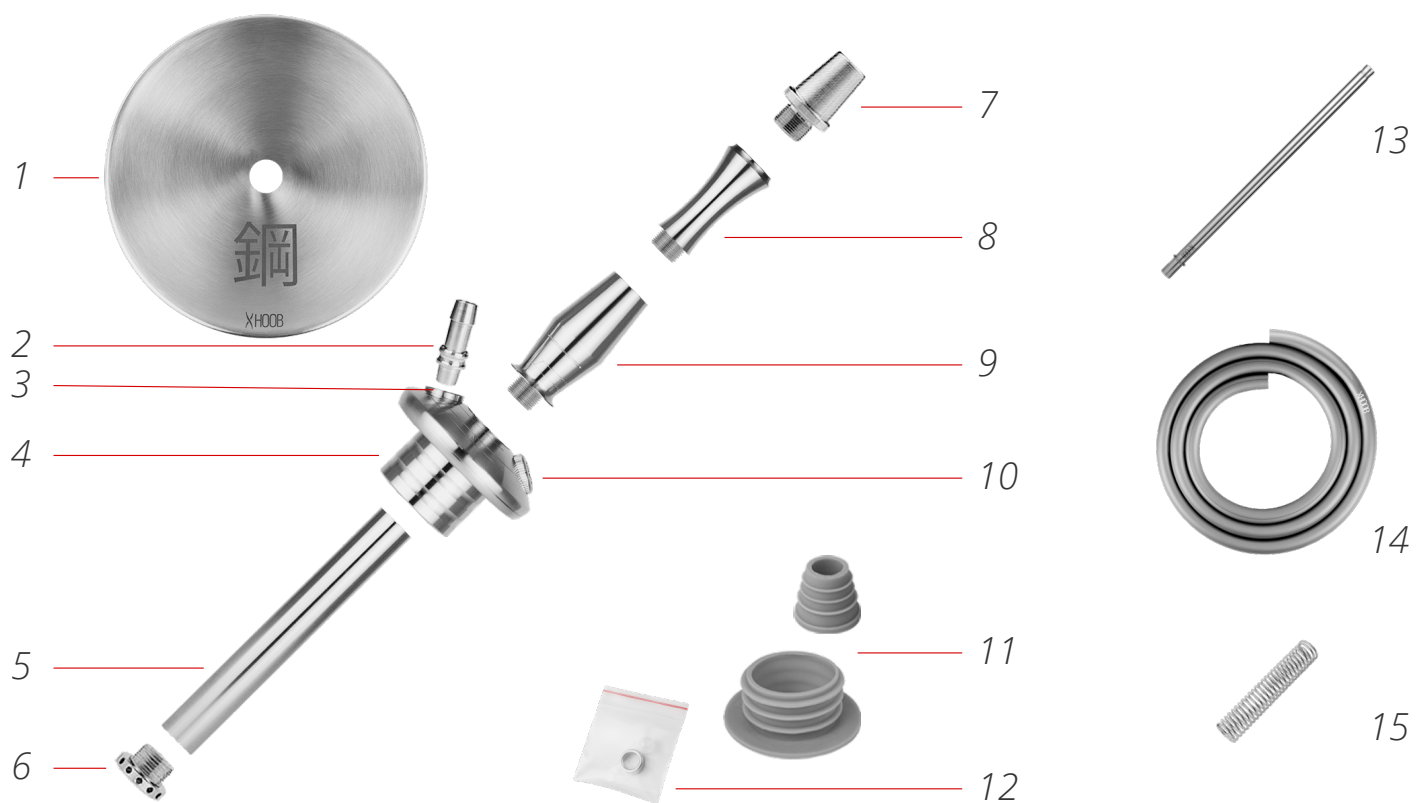

1. Fixed charcoal tray
2. Magnetic hose connector
3. Connector port
4. Magnetic base
5. Downstem tube
6. Diffuser

7. Bowl adapter
8. Stem tube №2
9. Stem tube №1
10. Purge valve cap
11. Bowl and base grommet
12. Set of spare parts

13. Hose handle
14. Silicone hookah hose
15. Hose spring

HOOKAH ASSEMBLY

Threaded connections should be twisted easily, without unnecessary effort clockwise.

We recommend moistening the vase seal and hose with water in order to make assembly easier.



Step 1

Screw the stem tube №1 tube to the magnetic base of the hookah.



Step 2

Screw the stem tube №2 tube.



Step 3

Attach the charcoal tray and fix it with the bowl adapter.



Step 4

Screw the downstem tube to the magnetic base of the hookah.



Step 5

Screw the diffuser to the downstem tube.



Step 6

Insert the hose connector into the hookah base.

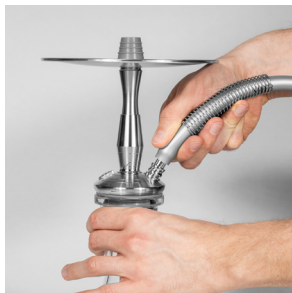

Step 7

Put the spring on the hose.

Pull the hose and spring up to the locking rim of the connector.



Step 8

Fix the spring at the base of the hookah.

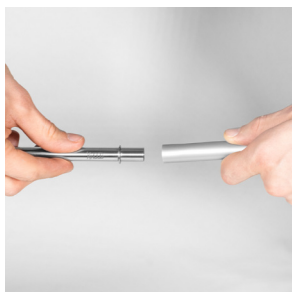

Step 9

Put the silicone hose on the tip, which is located at the bottom part of the hose handle.

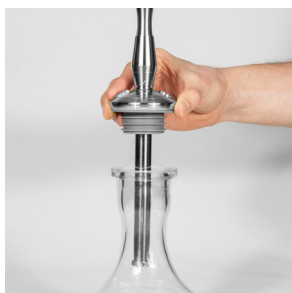

Step 10

Attach the base into the hookah vase.

Moisten the grommet of the neck with water in order to make assembly of the base easier. The hookah is ready for use.

HOOB CYBER

Color options:



SERVICE

Check the condition of the magnetic ring in the connector port.

If there are marks of damage to the coating or rust, the magnet should be replaced.



step 1

Attach the connector without a hose into the connector port.

With pressure on the connector port.

Unscrew the port counterclockwise.



Step 2

Remove the magnetic ring together with connector port.

Check the condition of the magnet.



A set of spare parts

- Magnetic ring
- Plastic ball into the purge valve

If you find it difficult to replace the magnets yourself or carry out hookah maintenance, there is an opportunity to use a paid service at the Hoob service center.

ACCESSORIES

The necessary equipment for using a hookah.



Glass vase



Bowl

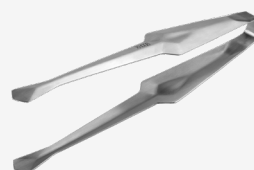

Togs



Heat
management
devices

WARNINGS

- Follow fire safety regulations.
- Do not touch the hookah parts exposed to heat with your hands until they cool down completely.
- Place the hookah on a flat surface for better stability.
- Wait until all sides of the coal are completely warmed up.



Hookahs with green, blue and purple coating on the charcoal tray are vulnerable to fruit acids. Which are contained in pineapple, orange, apple and other fruits used in the form of a fruit bowl for hookah.

OPTIONAL ACCESSORIES

Increase the comfort of using and transporting the hookah.



Coal burner



Fork



Windcover



Molasses catcher



Carrying bags

TECHNICAL SPECIFICATIONS

Hookah height:	30 cm
Weight:	1,15 kg
Inner diameter of the stem:	13 mm
Mounting of the stem to the vase:	silicone grommet
Stem-to-base connection hole:	45 mm
Hose connector type:	magnetic

Dear user!

If you have any questions related to the purchase, operation and maintenance of HOOB products, you contact us:

If you are in Russia, call tel.: +7 (495) 432 46 62

WhatsApp: +7 (916) 077 46 62

Telegram: @hoob_telebot

